



MBRL20300FCT

SCHOTTKY BARRIER RECTIFIERS

Reverse Voltage - 300 Volts Forward Current - 20.0 Amperes

FEATURES

- Low cost.
- Low leakage.
- Low forward voltage drop.
- High current capability.
- Easily cleaned with Alcohol, Isopropanol and Similar solvents.
- The plastic material carries U/L recognition 94V-0

MECHANICAL DATA

Case: TO-220F
Molding Compound: UL Flammability Classification Rating 94V-0
Terminals: Matte tin-plated leads; solderability-per MIL-STD-202, Method 208

TO-220F

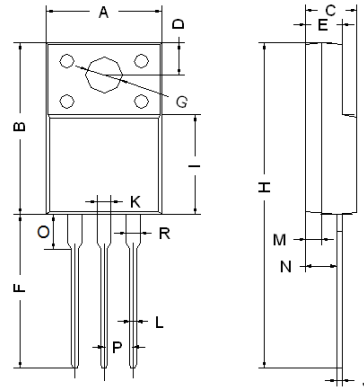

TO-220F		
Dim	Min	Max
A	9.80	10.30
B	15.20	15.80
C	4.37	4.77
D	2.90	3.30
E	2.50	2.90
F	12.90	13.50
G	3.10	3.30
H	28.40	29.16
I	8.40	9.10
J	0.35	0.58
L	0.68	0.94
M	1.30	1.50
N	2.40	2.60
O	2.60	3.10
P	2.40	2.60
K/R	1.10	1.32

All Dimensions in mm

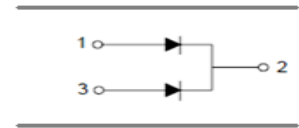
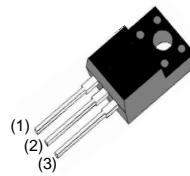

3 电特性

3.1 极限值

$T_{amb} = 25^{\circ}\text{C}$

参数名称	符号	额定值	单位
峰值反向电压	V_{RM}	300	V
正向电流 (注)	$I_{F(AV)}$	20	A
结温	T_j	150	$^{\circ}\text{C}$
贮存温度	T_{stg}	-40~150	$^{\circ}\text{C}$

注: 测试脉冲宽度 $t_p < 5\text{ms}$ 。

3.2 电参数

$T_{amb} = 25^{\circ}\text{C}$

参数名称	符号	测试条件	规范值			单位
			最小	典型	最大	
击穿电压 (注)	V_{BR}	$I_R = 100 \mu\text{A}$	300	—	—	V
反向电流 (注)	I_R	$V_R = 300\text{V}$	—	—	500	nA
正向电压 (注)	V_F	$I_F = 10\text{A}$	—	—	0.95	V

注: 测试直流参数时, 用最小自加热效应短持续时间的脉冲测试, 脉冲宽度 $t_p \leq 300\mu\text{s}$, 占空比 $\delta \leq 2\%$ 。